

DN	L	EN1092-2 PN16		H±5 (Max)	H1±5 (Max)	H2	ISO5211				
		ΦC	n-Φd				TOP	ΦN	ΦC1	n1-Φd1	Φc
40	33	110	4-19	126	52	29	F05	65	50	4-8	12.6
50	43	125	4-19	143	57	29	F05	65	50	4-8	12.6
65	46	145	4-19	155	68	29	F05	65	50	4-8	12.6
80	46	160	8-19	160	82	29	F05	65	50	4-8	12.6
100	52	180	8-19	181	100	29	F07	90	70	4-10	15.77
125	56	210	8-19	194	112	29	F07	90	70	4-10	18.92
150	56	240	8-23	202	126	29	F07	90	70	4-10	18.92
200	60	295	12-23	240	162	35	F10	125	102	4-12	22.1

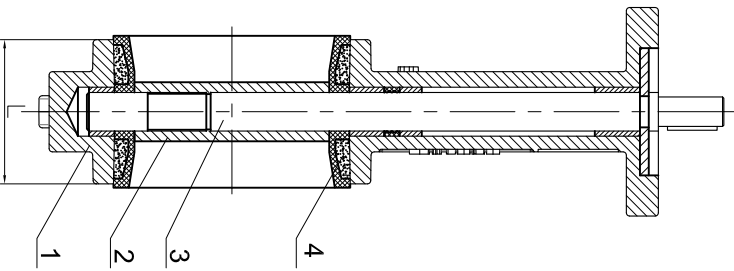
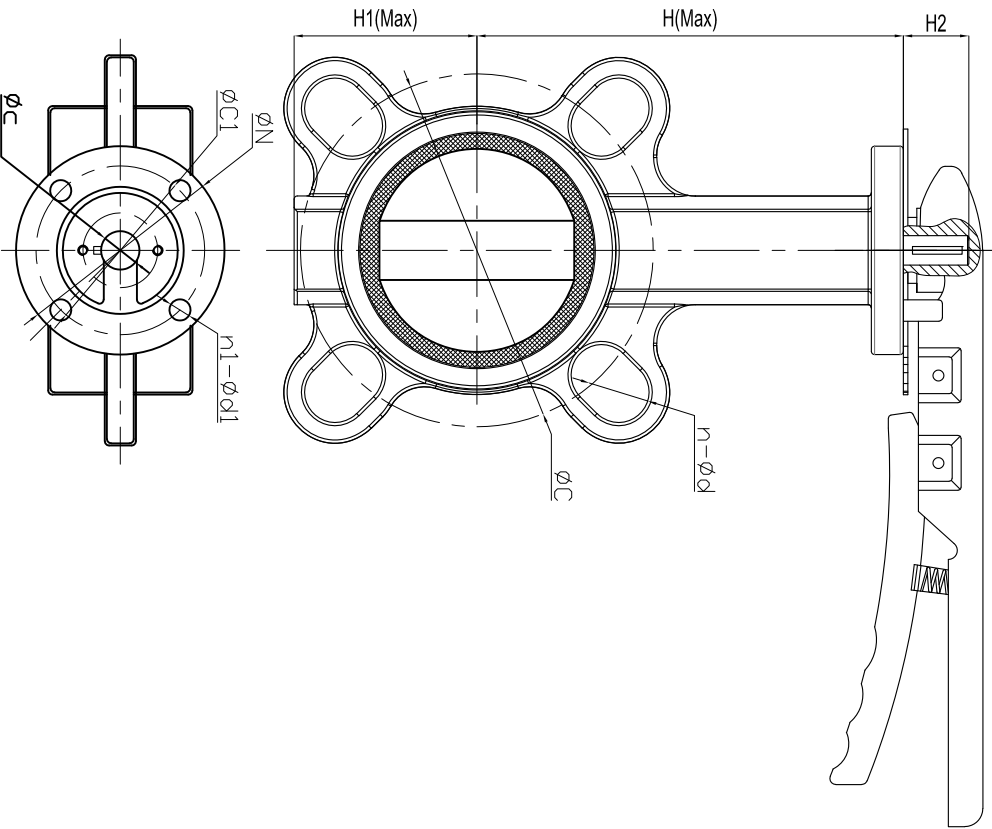

- Specification:**
- 1.General: ISO 5752
 - 2.Face to face: EN558-1 20 series
 - 3.Inspection and test: API 598
 - 4.Mounting pad: ISO 5211
 - 5.Flange drill: EN1092-2 PN16
 - 6.Workpressure: PN16

NO.	Name	Material
1	Body	Ductile Iron
2	Disc	DI+Ni/SS304
3	Stem	SS416
4	Seat	EPDM

DRN	WANG	WEIGHT	MATERIAL
CHK		SCALE	Butterfly Valve
APP		DATE	
		07/20/2024	B15W-HJ

Hiwa

REV 20240720a